

ESRAY A.S.

Technical Specifications of Bogies Y25-Ls-C, Y25-Lsi-C and Y25-Lsi(f)-C types of Bogies

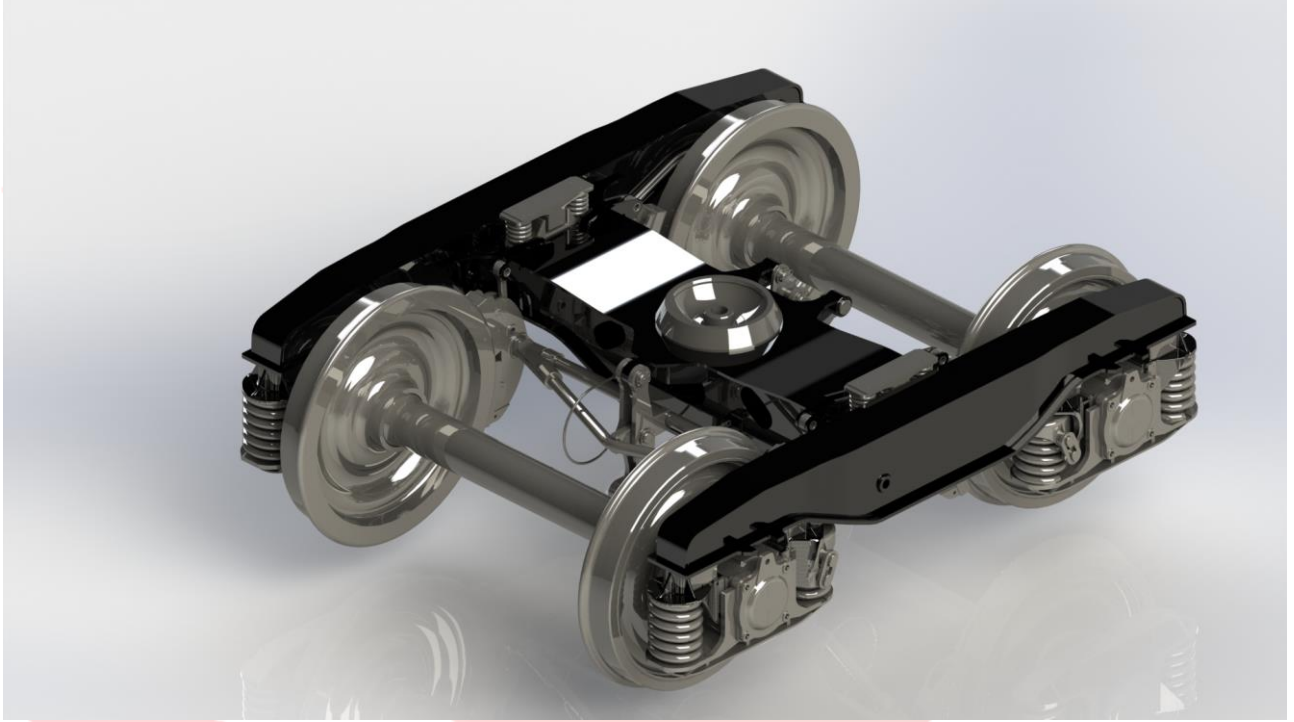

1) GENERAL

The bogies “Y25-Ls-C, Y25-Lsi-C and Y25-Lsi(f)-C” are two – axle bogies designed and approved as interoperability constituent in accordance with TSI-WAG. For the freight wagons. The main connecting dimension correspond with UIC-510-1. Max. Speed 100km/h at max. load 22.5 t/axle regime “S”.

2) MAIN CHARACTERISTICS

Track gauge	1435 mm
Wheel diameter	Max Ø920 mm Min Ø840 mm
Axle journal length	191 mm
Height of the bogie pivot centre above the top of the rail at wagon 20 t including weights of both bogies	925 (+3/-5) mm
Wheelbase	1800 mm
Distance between axle bearing centres	2000 mm
Specific bogie suspension: - at axle load up to 6.63t - above 6.63t	2.45mm/t 0.93 mm/t
Cross clearance of axle guards	2x10 mm
Tare weights (without top pivot part)	4.000 Kg (± %2)

